

# The Vulcan Center Hanger

The highest quality approach to scaled center hanger suspensions.

This bracket is designed to work with the Vulcan 15" side connector Super-Beam™ load cell to scale multi-axle trailer suspensions without modifying the trailer frame.

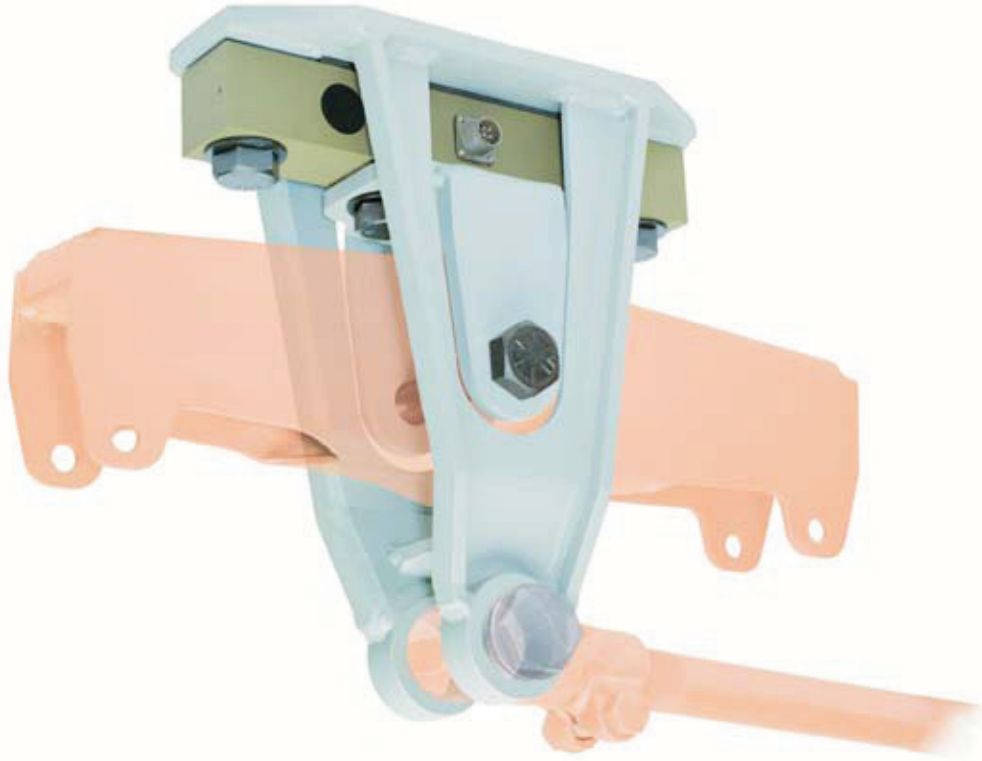

**H26 CENTER HANGER**  
(15" side connector Super-Beam™ load cell,  
equalizer, and torque arm not included)

## KEY BENEFITS:

- Easy installation - bracket is welded in place, just like a normal hanger
- Bolt in load cell for the highest accuracy, reliability and ease of installation
- Load cell is not affected by torque arm load
- The H26 Center Hanger features a split bushing torque arm connection for maximum durability
- The H26 Center Hanger is compatible with fabricated H-7600, H-7700, H-9600, H-9700, and several other manufacturer's suspension configurations with a 49" to 67" axle spread
- The H32 Center Hanger is directly compatible with fabricated H-7700 and H-9700 suspensions with a 49" to 67" axle spread
- Excellent for both on-road and off-road applications

**QUALITY, DEPENDABILITY, SIMPLICITY FROM  
THE WORLD LEADER IN ON-BOARD SCALES**



## CENTER HANGER

CENTER HANGER  
FOR MULTI-AXLE TRAILER  
SUSPENSIONS

### UNITED STATES

STRESS-TEK, INC.  
5920 SOUTH 194th STREET  
KENT WASHINGTON 98032  
PHONE: 253 872-1910  
800 237-0022  
FAX: 253 872-9626  
EMAIL : [info@vulcanscales.com](mailto:info@vulcanscales.com)  
[www.vulcanscales.com](http://www.vulcanscales.com)

### CANADA

STRESS-TEK, INC.  
UNIT #11  
1642 LANGAN AVENUE  
PORT COQUITLAM B.C.  
V3C 1K5  
PHONE: 800 663-0854

# VULCAN CENTER HANGER

H26 CENTER HANGER  
(SPLIT BUSHING)

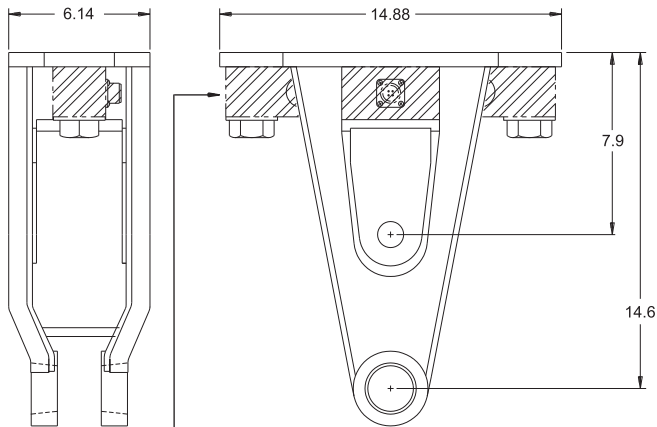

VULCAN SUPER-BEAM™  
LOAD CELL (L02)  
ORDER SEPARATELY

H32 CENTER HANGER

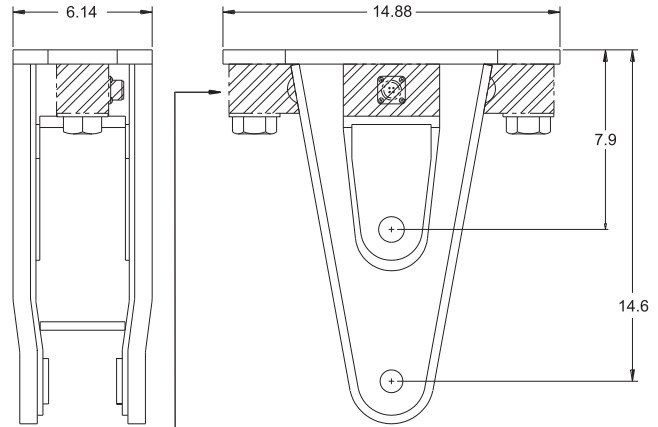

VULCAN SUPER-BEAM™  
LOAD CELL (L02)  
ORDER SEPARATELY

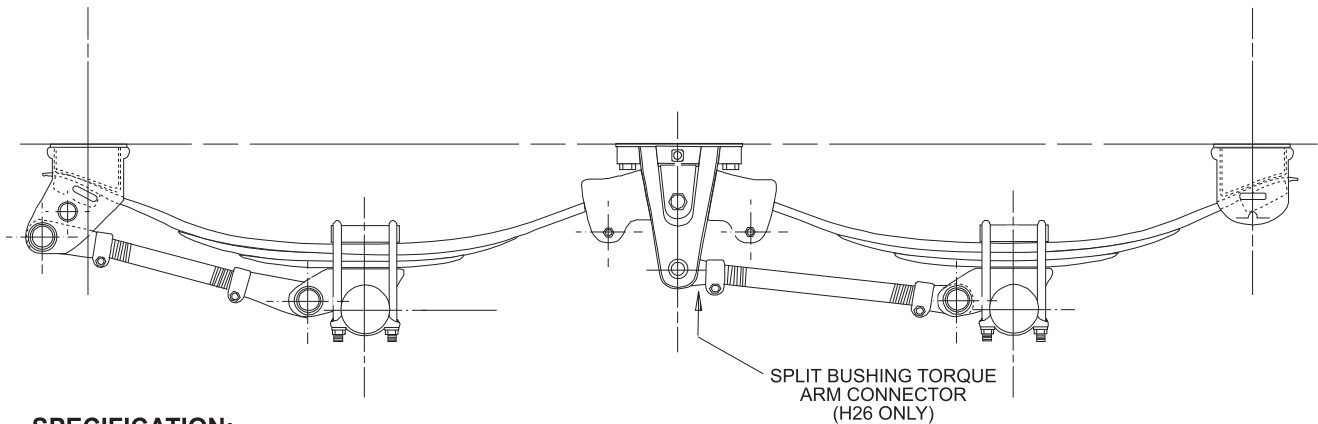

## SPECIFICATION:

**CAPACITY:** Maintains the original system capacity

**ACCURACY:** Typical system error less than  
1% full scale

**MATERIAL:** High strength alloy steel

**FINISH:** Vulcan center hangers are painted  
with a weld through primer

**INCLUDES:** Load cell mounting hardware

## REPRESENTED BY: